

STEEL STITCH

FASTER, EASIER, BETTER AWNINGS SINCE 1988

- ◇ STAPLE-IN AWNING FRAME EXTRUSIONS
- ◇ PVC ZIPSTRIP STAPLE-CHANNEL TRIM
- ◇ FABRIC ZIPSTRIP STAPLE-CHANNEL TRIM
- ◇ PRODUCTION TOOLS
- ◇ ACCESSORIES



Distributed By:

TRIVANTAGE

ORDER. DONE. GOOD CALL.



The Steel Stitch™ Method

The Steel Stitch™ Method is the Fastest, Easiest and Best way to fabricate fabric awnings and canopies. Staples are driven into a cross web located inside the Steel Stitch™ tube, attaching the fabric securely to the awning frame. Covers can pass over non staple-in frame members or be stapled to some or all frame member that the cover contacts. After the cover is stapled and trimmed, the staple channel is concealed with Steel Stitch™ PVC or Fabric Covered ZipStrip which is quickly driven into the channel with a small pneumatic hammer.

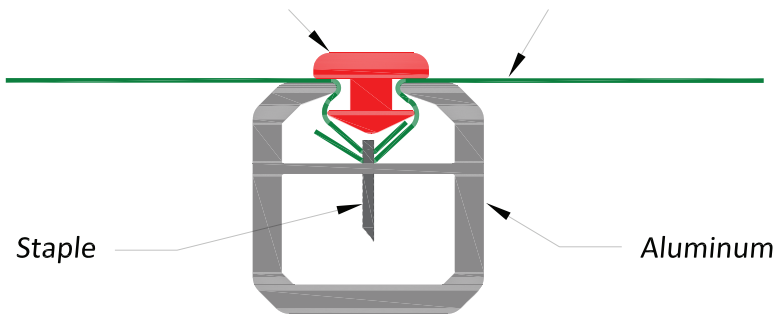

As most people familiar with the method will attest, covering awnings with this method is faster and easier than other methods. This is particularly true for more complicated shapes, since it eliminates the need for patterning of the cover. The more complicated the shape, the more time you'll save stapling the cover. Fabrics that craze (thin white lines on the fabric caused by folding or creasing the fabric) can be particularly difficult to work with when making a large sewn or welded cover, a problem avoided by stapling the fabric directly to the frame without the need for excessive handling. Making sewn or welded awning covers can take several years to master, where stapling can be learned in days and mastered in weeks.

Stapling is certainly easier, but none of that matters if the quality doesn't match up with other methods of awning construction. And that's where Steel Stitch™ awnings really shine. Because it is easier, stapled covers fit drum tight, with little to no wrinkles. On the other hand, fabricators that use more difficult, time consuming methods often have to make numerous alterations to a cover before they can achieve a proper fit. Often, because of deadlines or cost concerns, they accept poor fitting covers. The result not only affects the appearance of the awning but also the durability as loose fitting covers wear more rapidly as they blow in the wind and rub against the awning frame.

Another area where the Steel Stitch™ method is particularly advantageous is in building large canopies like patio and walkway covers. To produce a durable cover for these large structures, the covers should be attached not only at the perimeter (railroaded) but to most if not all rafters. This is the only way to transfer uplift wind loads to the entire frame, not just the perimeter. Stapling to those rafters is much easier than other methods like sewing a pocket or flap on the underside of the cover that is laced or screwed to the frame. As with taking the time and effort to make covers that fit well, this is a step that some fabricators won't take the time to do properly unless they can do it quickly and easily with the Steel Stitch™ method.

TABLE OF CONTENTS

The Steel Stitch™ Method	2
Table of Contents (this page)	3
Aluminum Extrusions	
Staple Channel	4, 5, 6
Square Tubing	7
Standard Shapes	8, 9
PVC ZipStrip®	10
Fabric ZipStrip®	11
FlashStrip	12
Equipment & Accessories	13, 14
Notes	15
Contact Information	(back cover) 16



Steel Stitch Item No.	Trivantage Item No.	Length	Standard Bundle	Wgt per Bundle
SMP-1B	250052	25'	10 pcs	122 lbs

Generally used in spans up to 44" that are laterally supported against fabric tension at a maximum of 42".

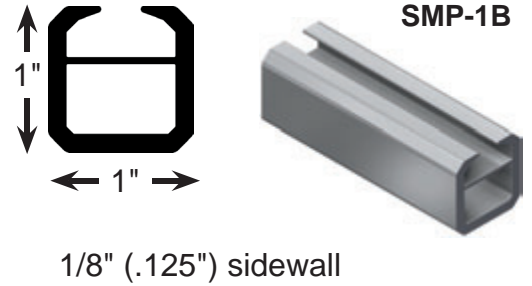

Steel Stitch Item No.	Trivantage Item No.	Length	Standard Bundle	Wgt per Bundle
SMP-1C	250054	25'	10 pcs	105 lbs

Generally used in spans up to 38" that are laterally supported against fabric tension at a maximum of 36".

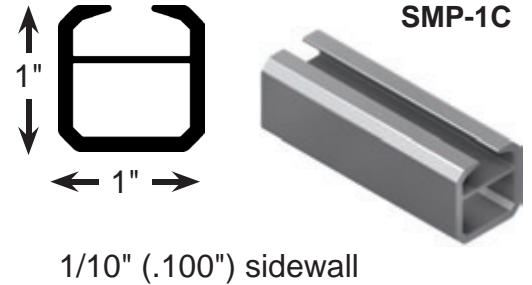

Steel Stitch Item No.	Trivantage Item No.	Length	Standard Bundle	Wgt per Bundle
SMP-1CD	250055	25'	10 pcs	90 lbs

Generally used in spans up to 34" that are laterally supported against fabric tension at a maximum of 30".

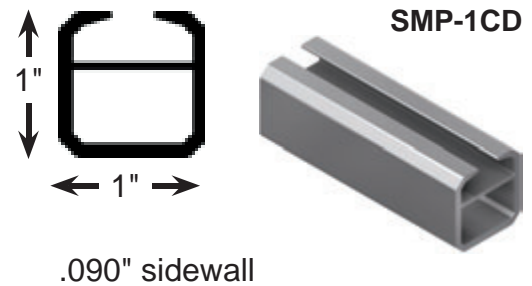

Steel Stitch Item No.	Trivantage Item No.	Length	Standard Bundle	Wgt per Bundle
SMP-2B	250058	25'	10 pcs	140 lbs

Generally used in spans up to 44" that are laterally supported against fabric tension at a maximum of 42", while providing support for drop-in ceiling panels.

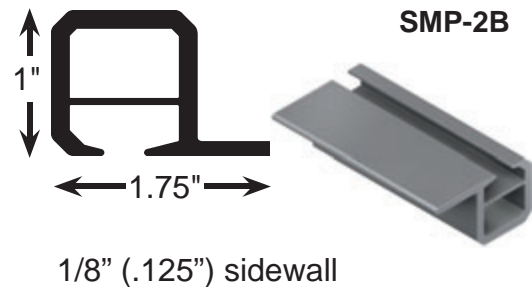

Steel Stitch Item No.	Trivantage Item No.	Length	Standard Bundle	Wgt per Bundle
SMP-3CP	250068	25'	10 pcs	120 lbs

Generally used as middle rafters to support drop-in ceiling panels.

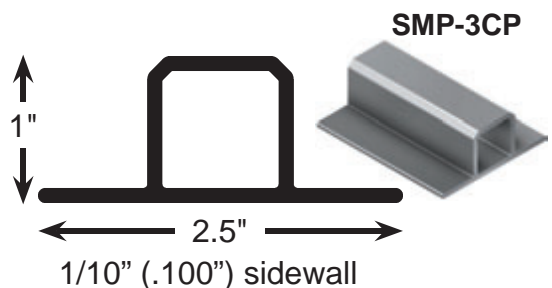

Staple Channel Aluminum Extrusions

Steel Stitch Item No.	Trivantage Item No.	Length	Standard Bundle	Wgt per Bundle
SMP-8B	250088	25'	10 pcs	220 lbs
Generally used in spans up to 81" that are laterally supported against fabric tension at a maximum of 50".				

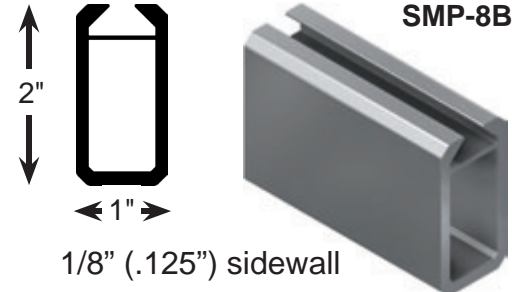

Steel Stitch Item No.	Trivantage Item No.	Length	Standard Bundle	Wgt per Bundle
SMP-8C	250088	25'	10 pcs	165 lbs
Generally used in spans up to 70" that are laterally supported against fabric tension at a maximum of 48".				

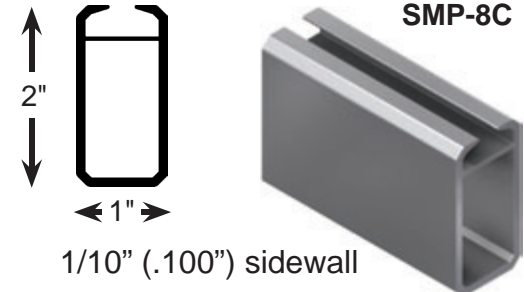

Steel Stitch Item No.	Trivantage Item No.	Length	Standard Bundle	Wgt per Bundle
SMP-15B	250097	25'	6 pcs	127 lbs
Generally used in spans up to 74" that are laterally supported against fabric tension at a maximum of 66".				

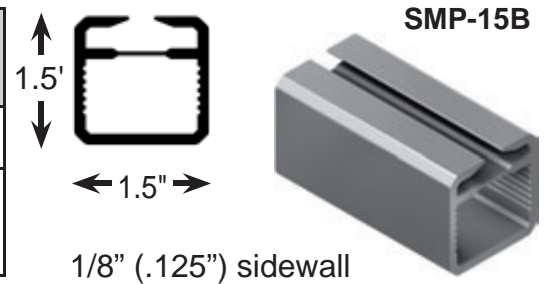

Steel Stitch Item No.	Trivantage Item No.	Length	Standard Bundle	Wgt per Bundle
SMP-22B	250099	25'	6 pcs	186 lbs
Generally used in spans up to 101" that are laterally supported against fabric tension at a maximum of 84".				

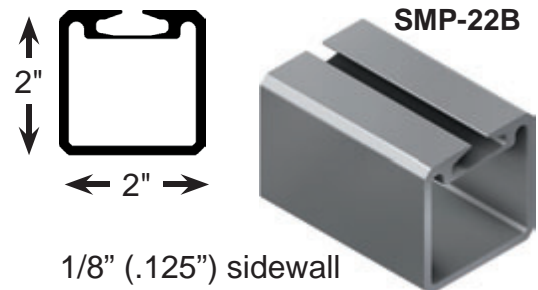

Approximate maximum allowable spans are for general guidance only. Consult an engineer registered in the state where your project is located for precise calculations for your specific project.

Steel Stitch Item No.	Trivantage Item No.	Length	Standard Bundle	Wgt per Bundle
SMP-9B	250092	25'	5 pcs	150 lbs
SMP-9BS	250094	25'	5 pcs	150 lbs

Generally used in spans ranging from 84" to 120" that are laterally supported against fabric tension at a maximum of 50".

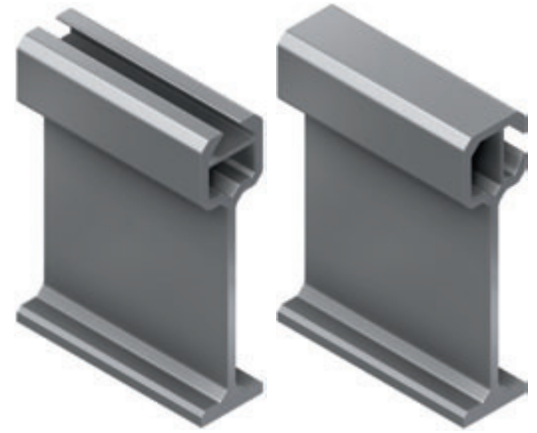

SMP-9B

SMP-9BS

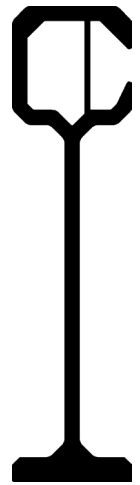

Approximate maximum allowable spans are for general guidance only. Consult an engineer registered in the state where your project is located for precise calculations for your specific project.

See more samples in our Online Gallery at www.steelstitch.com

Square Tubing Aluminum Extrusions

Steel Stitch Item No.	Trivantage Item No.	Length	Standard Bundle	Wgt per Bundle
SMP-4B	250074	25'	10 pcs	124 lbs
Chamfered corners to match staple in profiles. Typically used as cross members.				

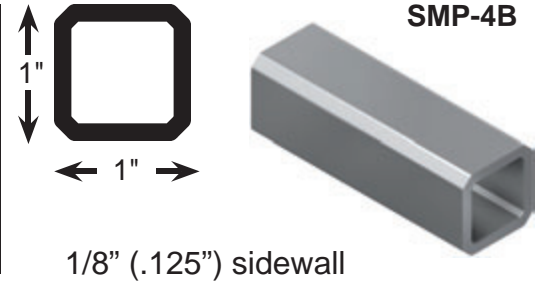

Steel Stitch Item No.	Trivantage Item No.	Length	Standard Bundle	Wgt per Bundle
SMP-4C	250078	25'	10 pcs	101 lbs
Chamfered corners to match staple in profiles. Typically used as cross members.				

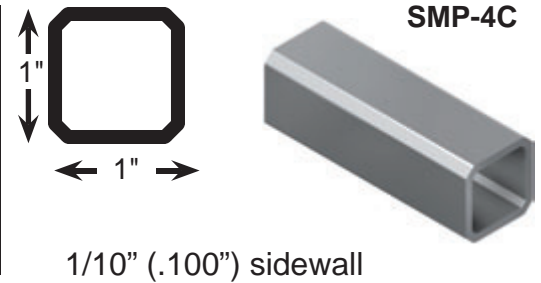

Steel Stitch Item No.	Trivantage Item No.	Length	Standard Bundle	Wgt per Bundle
SMP-4D	250080	25'	10 pcs	67 lbs
Chamfered corners to match staple in profiles. Typically used as cross members.				

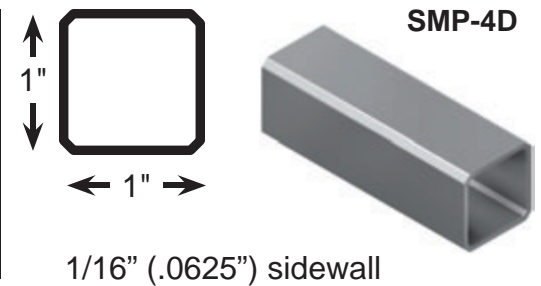

Square Tube

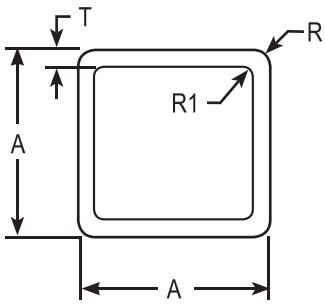

A (inches)	T (inches)	R (inches)	R1 (inches)	Description	Alloy & Temper	Steel Stitch Item No.	Length (feet)	Pieces per Bundle	Approx Wgt/Ft.	Approx. Bundle Weight
1	0.06	0.125	0.06	Tube, Sq. 1 x 1 x .060 radius cnr	6063-T6	SMP-500	20	10	0.259	52
1	0.125	0.032	0.032	Tube, Sq. 1 x 1 x .125 radius cnr	6063-T6	SMP-501	25	10	0.509	128
1.5	0.125	0.032	0.032	Tube, Sq. 1.5 x 1.5 x .125 sharp cnr	6063-T6	SMP-502	20	10	0.825	165
2	0.125	0.188	0.07	Tube, Sq. 2 x 2 x .125 radius cnr	6063-T6	SMP-503	20	10	1.109	222
3	0.125	0.19	0.068	Tube, Sq. 3 x 3 x .125 radius cnr	6061-T6	SMP-504	20	4	1.709	137
4	0.125	0.125	0.063	Tube, Sq. 4 x 4 x .125 radius cnr	6061-T6	SMP-505	20	4	2.313	185

Round Tube

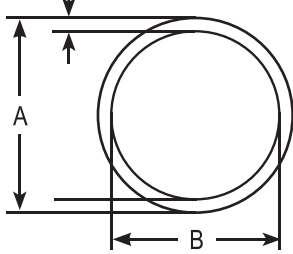

A (inches)	T (inches)	B (inches)	Description	Alloy & Temper	Steel Stitch Item No.	Length (feet)	Pieces per Bundle	Approx Wgt/Ft.	Approx. Bundle Weight
1	0.125	0.75	Tube, Round 1 x .125	6063-T6	SMP-506	20	10	0.412	82
3	0.125	2.75	Tube, Round 3 x .125	6061-T6	SMP-507	20	3	1.355	81
4	0.125	3.75	Tube, Round 4 x .125	6061-T6	SMP-508	20	4	1.826	146

Bar

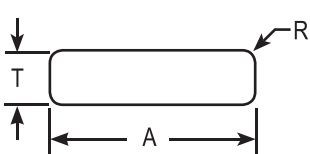

A (inches)	T (inches)	R (inches)	Description	Alloy & Temper	Steel Stitch Item No.	Length (feet)	Pieces per Bundle	Approx Wgt/Ft.	Approx. Bundle Weight
1	0.188	0.015	Bar 1 x .188 Sharp Cnr	6063-T5	SMP-6	20	10	0.225	45
6	0.25	0.062	Bar 6 x .250 Sharp Cnr	6061-T6	SMP-510	12	6	1.796	129
8	0.5	0.015	Bar 8 X 0.50 Sharp Cnr	6061-T6	SMP-511	12	2	4.8	115

Rod

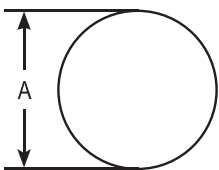

A	Description	Alloy & Temper	Steel Stitch Item No.	Length (feet)	Pieces per Bundle	Approx Wgt/Ft.	Approx. Bundle Weight
0.5	Rod 0.50	6063-T5	SMP-7	20	10	0.236	47

Schedule 40 Pipe

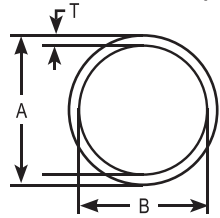

A (inches)	T (inches)	B (inches)	Size	Description	Alloy & Temper	Steel Stitch Item No.	Length (feet)	Pieces per Bundle	Approx Wgt/Ft.	Approx. Bundle Weight
1.315	0.133	1.049	"1" SCH 40"	"Pipe, I.P.S. Structural 1" SCH 40"	6063-T6	SMP-513	20	10	0.593	119

Rectangular Tube

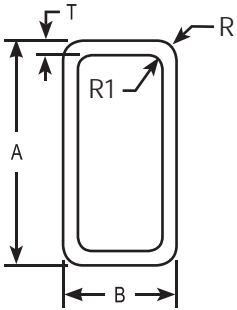

A (inches)	B (inches)	T (inches)	R (inches)	R1 (inches)	Description	Alloy & Temper	Steel Stitch Item No.	Length (feet)	Pieces per Bundle	Approx Wgt/Ft.	Approx. Bundle Weight
	1	0.125	0.188	0.07	Tube, Rect'r 1 x 2 x .125 radius cnr	6063-T6	SMP-515	20	10	0.825	165

PVC ZipStrip Stock Colors in 400 ft. or 150 ft Rolls

Cover your staple-in channels with speed and ease using ZipStrip and a palm held air hammer. Low profile crown allows ends to be tucked under crossing trim for a clean finish. In all 31 colors plus clear.

Shipping weight: 400' roll = 24 lbs
 150' roll = 12 lbs

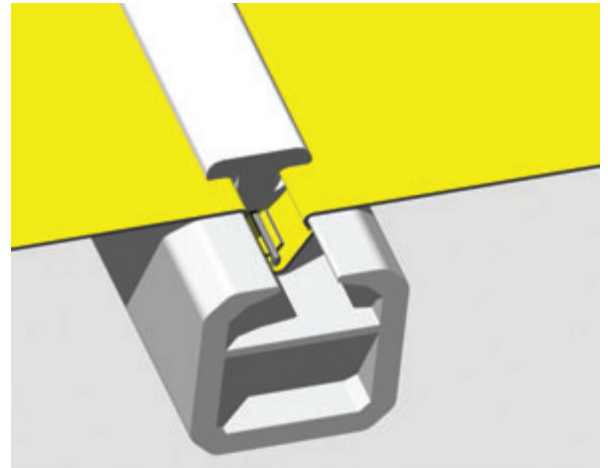

400' Rolls of PVC ZipStrip	Trivantage item #
01 White	249901
02 Black	249902
03 Gray	249903
04 Cream	249904
05 Beige	249905
06 Brown	249906
09 Rose	249909
10 Plum	249910
11 Burgundy	249911
12 Rouge Red	249912
13 Dark Blue	249913
14 Medium Blue	249914
15 Sky Blue	249915
16 Aquamarine	249916
17 Grass Green	249917
18 Dark Green	249918
19 Yellow	249919
20 Pumpkin	249920
21 Terra Cotta	249921
22 Linen	249922
23 Deep Red	249923
24 Bright Red	249924
25 Royal Blue	249925
26 Bright Blue	249926
27 Teal	249927
28 Turquoise	249928
29 Golden Yellow	249929
30 Bright Orange	249930
31 Clear	249931
32 Violet	249932
33 Bordeaux	249934
34 Magenta	249935

150' Rolls of PVC ZipStrip	Trivantage item #
01 White	250301
02 Black	250302
03 Gray	250303
04 Cream	250304
06 Brown	250306
10 Plum	250310
11 Burgundy	250311
12 Rouge Red	250312
13 Dark Blue	250313
16 Aquamarine	250316
17 Grass Green	250317
18 Dark Green	250318
19 Yellow	250319
20 Pumpkin	250320
21 Terra Cotta	250321
22 Linen	250322
23 Deep Red	250323
24 Bright Red	250324
25 Royal Blue	250325
26 Bright Blue	250326
27 Teal	--
28 Turquoise	250328
29 Golden Yellow	250329
30 Bright Orange	250330
31 Clear	250331
32 Violet	250332
33 Bordeaux	250334

With Sunbrella®, Firesist or Special Order Fabric Covers

- Make the best looking staple-in awnings. No more PVC trim next to your attractive woven canvas covers. Fabric ZipStrip® creates a fantastic hand crafted look your customers are sure to love.
- The fabric wraps around the ZipStrip® cap completely concealing the PVC material. The lockstitch double seam holds the fabric securely in place for years of durable performance
- Fabric ZipStrip® features the identical insert design as our regular ZipStrip® so it drives in easily and stays put.



U.S. Patent 7,699,091
 Average roll size 175 ft. (will vary)
 Shipping Weight: 13 lbs. per 175 ft roll
 Pkg. Size: 15" x 15" x 5"

Choose your thread! Color-matched, solution-dyed polyester or Tenara®.

Standard Sunbrella® Colors		
Color	Trivantage item # (Polyester Thread)	Trivantage item # (Tenara Thread)
Alpine	249899	--
Beige	249879	249825
Black	249878	249813
Black Cherry	249877	--
Burgundy	249891	249816
Cadet grey	249890	249821
Captain Navy	249896	249819
Charcoal Gray	--	249808
Forest green	249894	249818
Heather Beige	--	249829
Jockey Red	249873	249811
Linen	249893	249817
Mediterranean Blue	--	249827
Navy	249876	249820
Oyster	249897	--
Pacific Blue	249871	249810
Persian Green	249875	--
Seagrass Green	249895	249823
Ivy	249898	--
Taupe	--	249809
Terra Cotta	249881	249814
Toast	249882	249815
True Brown	249880	249824

Standard Firesist® Colors		
Color	Trivantage item # (Polyester Thread)	Trivantage item # (Tenara Thread)
Admiral Navy	249837	249857
Black	249836	249856
Burgundy	249844	--
Crimson Red	249845	249865
Forest Green	249833	249853
Forest Green Tweed	249832	--
Grey	--	--
Ivory	--	--
Regatta	249831	249851
Regatta Tweed	--	--
Sand	249835	249855
Sunburst Yellow	249839	249859
Terra Cotta	--	--
Toasty Beige	249838	--

If the color or fabric type you are wishing to match is not listed, then we can likely make it for you as a SPECIAL ORDER in most popular awning fabrics including:

- | | |
|------------------------|----------------------------------|
| Other Sunbrella Color | Weatherlyte® & Weatherlyte® Lite |
| Other Firesist® Colors | Main Street® |
| Dickson® | Weblon® |
| Natura™ | Sattler® Elements |
| Eradi-Lite® | Soltis® 92 |

Contact Steel Stitch for Assistance with you Special Order Fabric ZipStrip.
 Minimum order - 100 ft.

Sunbrella®, Firesist®, Main Street®, Weblon®, Eradi-Lite®, Dickson® is a registered trademark of Glen Raven, Inc. Tenara® is a registered trademark of W. L. Gore and Associates. Soltis® is a registered trademark of The Serge Ferrari Groupptyte®. Weatherlyte is a registered trademark of the Cooley Group. Natura™ is a trademark of Herculite Products Inc.

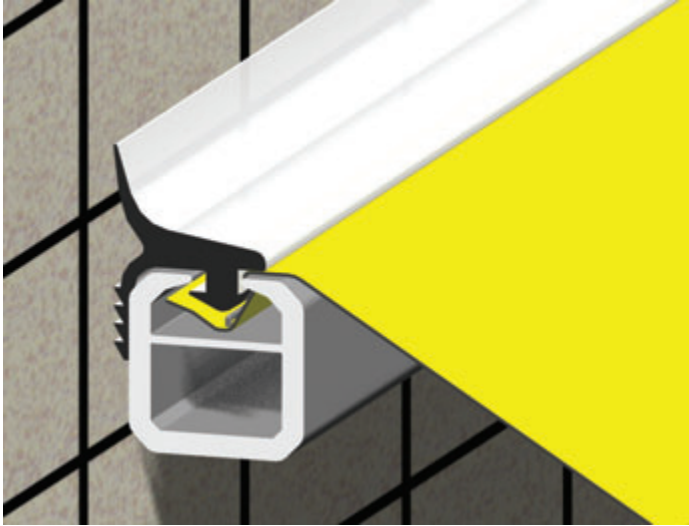

FlashStrip

Create a secure seal against water leakage without having to climb on top of your awnings to caulk. FlashStrip drives into the awning back bar and conforms to the wall. Works great on synthetic stucco, brick, block and other irregular surfaces. In clear only, to allow substrate to show through.

125' roll: Clear only
Shipping weight 22 lbs
Trivantage # 249950

BEHRENS/BeA PNEUMATIC STAPLER



Years of Industrial-Grade Performance

If your business requires a staple gun that performs day after day, year after year, with minimal downtime, the Behrens/BeA gun is for you. Behind this exceptional performance is German precision engineering and all steel body construction.

Rated at 90 PSI, Steel Stitch recommends efficient operation at 75 PSI pressure. Shoots our wide crown staples.

Available with or without nose-actuated Safety.

Without Safety:

Trivantage Item # 250213

Weight: Approx. 3 lb.

With Nose-Actuated Safety:

Trivantage Item # 250162

Weight: Approx. 3 lb.



APACH PNEUMATIC STAPLER



Economy and Sturdy Construction

The LU-9225AC is a compact, lightweight pneumatic staple gun with an all-metal housing. Has rubber comfort grip. Comes with carrying/storage case, maintenance tools, and safety goggles. Shoots our wide crown staples.

Trivantage Item # 250216

Shipping Weight: Approx. 5 lbs.

Staple Gun Weight: 3 lbs. 10 oz.

Complete with Carrying Case & Goggles



STAPLES

Series	Material	Length	Point Style	Case Quantity	Case Weight	Trivantage No.
92	Galv Steel	9 mm (≈3/8")	Divergent Pt	10 boxes of 5000	25 lbs	250157
92	Galv Steel	12 mm (≈1/2")	Divergent Pt	10 boxes of 5000	28 lbs	250158
92	Galv Steel - resin coated	9 mm (≈3/8")	Chisel Pt	10 boxes of 5000	23 lbs	250205
92	Galv Steel - resin coated	12 mm (≈1/2")	Chisel Pt	6 boxes of 8400	27 lbs	250206
92	Stainless Steel	12 mm (≈1/2")	Divergent Pt	10 boxes of 5000	27 lbs	250202

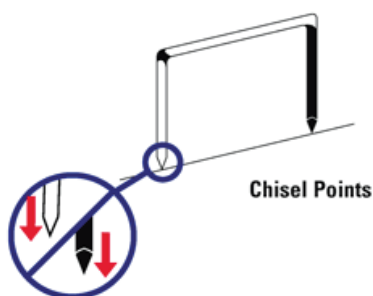

Chisel Points

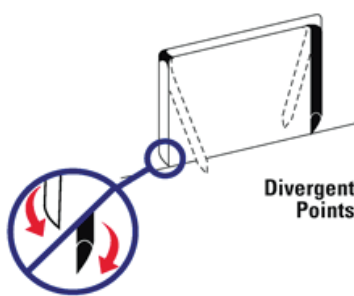

Divergent Points



PNEUMATIC HAMMER

The pneumatic PVC hammer is a hand held fabric shop tool that drives PVC trims such as ZipStrip® and DividerStrip® into place. After extensive testing, Steel Stitch™ has determined the Danair Pneumatic Hammer (Made in the USA) to be consistently more dependable and trouble-free than any other model tested. Steel Stitch™ recommends efficient operation at 75 PSI pressure.

Trivantage Item # 228030
 Standard Pkg. 1 each
 Weight: Approx. 2.5 lbs.



Dependable Quality!

RAISED HUB GRINDING DISKS

Rex-Cut Brand Raised Hub Aluminum Grinding Disk for grinding, polishing and weld removal. This product's resilient bonding provides smooth grinding action and permits easy control of cutting rate. Resists loading and offers excellent results when grinding aluminum. High resistance to separation for increased operator safety. For use with 4-1/2" angle grinders at a maximum safe operating speed of 12000 RPM.

Trivantage Item # 250153
 Weight: Approx. 6 oz. each



Distributed By:

TRIVANTAGE

ORDER. DONE. GOOD CALL.



www.trivantage.com

Mebane, North Carolina
1031 Corporate Park Dr
Mebane, NC 27302
877-540-6803

Miami, Florida
2281 NW 95th Ave
Miami, FL 33172
800-786-7605

Elmhurst, Illinois
957 N Oaklawn Ave
Elmhurst, IL 60126
800-786-7608

Cleveland, Ohio
18401 Sheldon Rd., Suite A
Middleburg Heights, OH 44130
800-786-7601

Atlanta, Georgia
422 Thornton Road
Lithia Springs, GA 30122
800-786-7606

Denver, Colorado
4909 Kingston St
Denver, CO 80239
800-786-7609

Somerset, New Jersey
16 Worlds Fair Drive
Somerset, NJ 08873
800-786-7602

Hayward, California
3507 Arden Rd
Hayward, CA 94545
800-786-7607

Dallas, Texas
300 Union Bower Court
Irving, TX 75061
800-786-7610

St. Louis, Missouri
45 Worthington Access Drive
Maryland Heights, MO 63043
800-786-7603

City of Industry, California
745 Epperson Dr
City of Industry, CA 91748
800-841-0555

Seattle, Washington
18417 Cascade Ave. South
Tukwila, WA 98188
800-213-1465

Rev. 1e

Steel Stitch™ Corporation

425 Wilbanks Drive

Ball Ground, GA 30107 USA

Phone: 770-213-2121 • Fax: 770-213-2122 • USA: 800-441-3316

sales@steelstitch.com

www.steelstitch.com



STEEL STITCH

FASTER, EASIER, BETTER AWNINGS SINCE 1988